

Board of Trustees

Institute of Paper Science and
Technology

Dr. G. Wayne Clough

President, Georgia Institute of Technology

October 25, 2001

Institute Overview

- Among the top 50 universities in the nation; top 10 public universities (*US News & World Report*)
- 15,500 students
 - 11,000 undergraduates
 - 4,500 graduate students
- Graduates most engineers in the nation
- 4,200 employees, 850 academic faculty, 1,300 “general” faculty
- Over \$300 m in sponsored research a year, 24 percent of it industry-sponsored

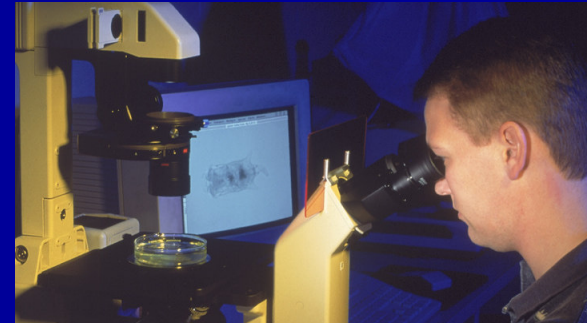

6 Colleges

Architecture

Computing

Engineering

Ivan Allen College

Management

Sciences



9 Engineering Schools

Aerospace

Biomedical

Chemical

Civil & Environmental

Electrical & Computer

Industrial & Systems

Materials Science

Mechanical

Textile & Fiber

Budget for Fiscal Year 2002

\$755.4 million

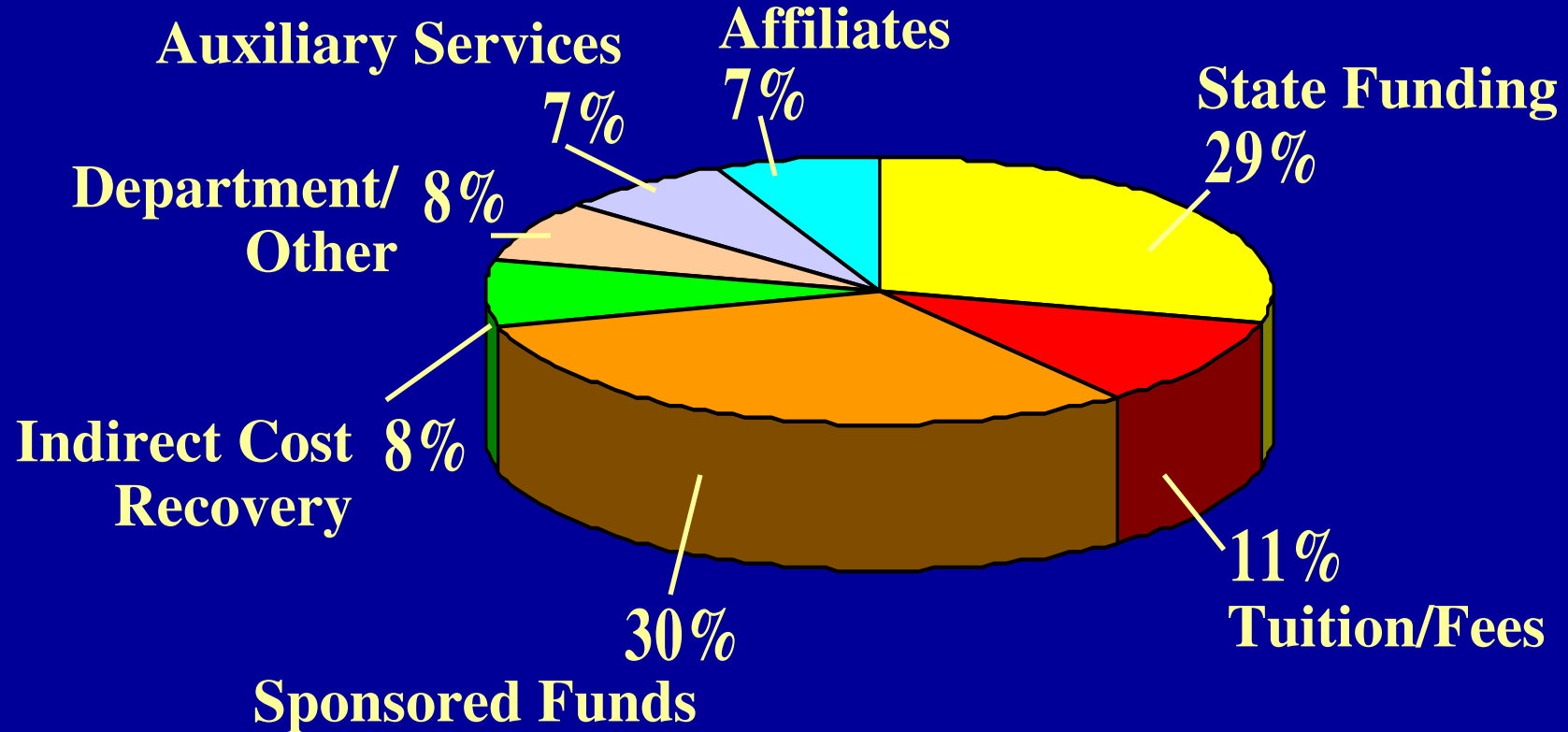

Outstanding Students

Freshman SAT Scores

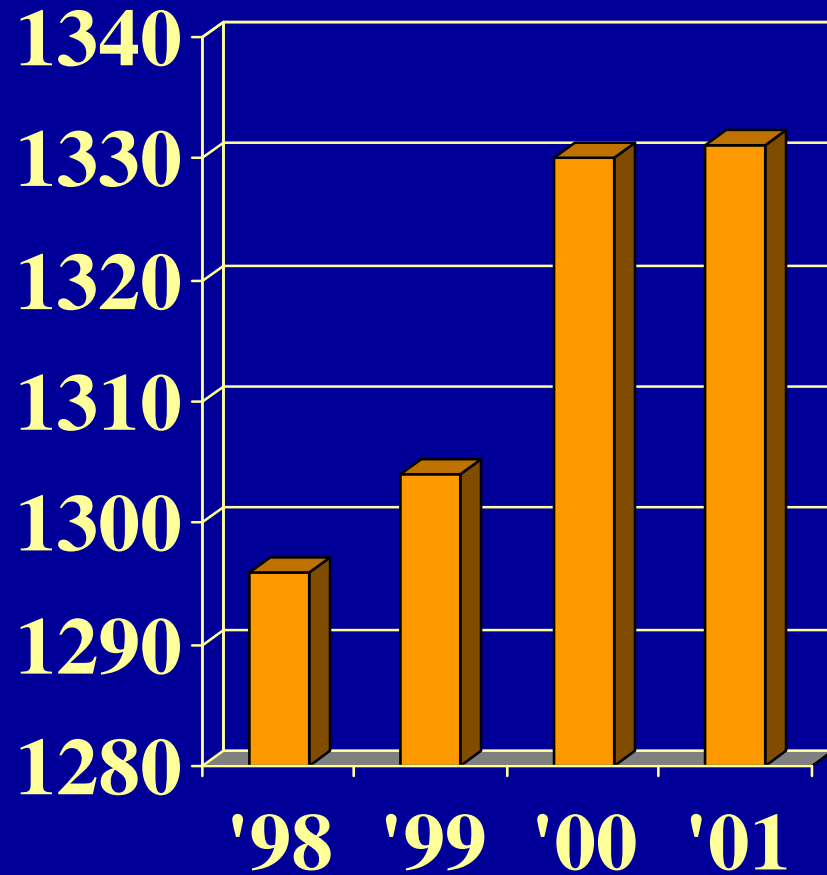

Graduate GRE Scores

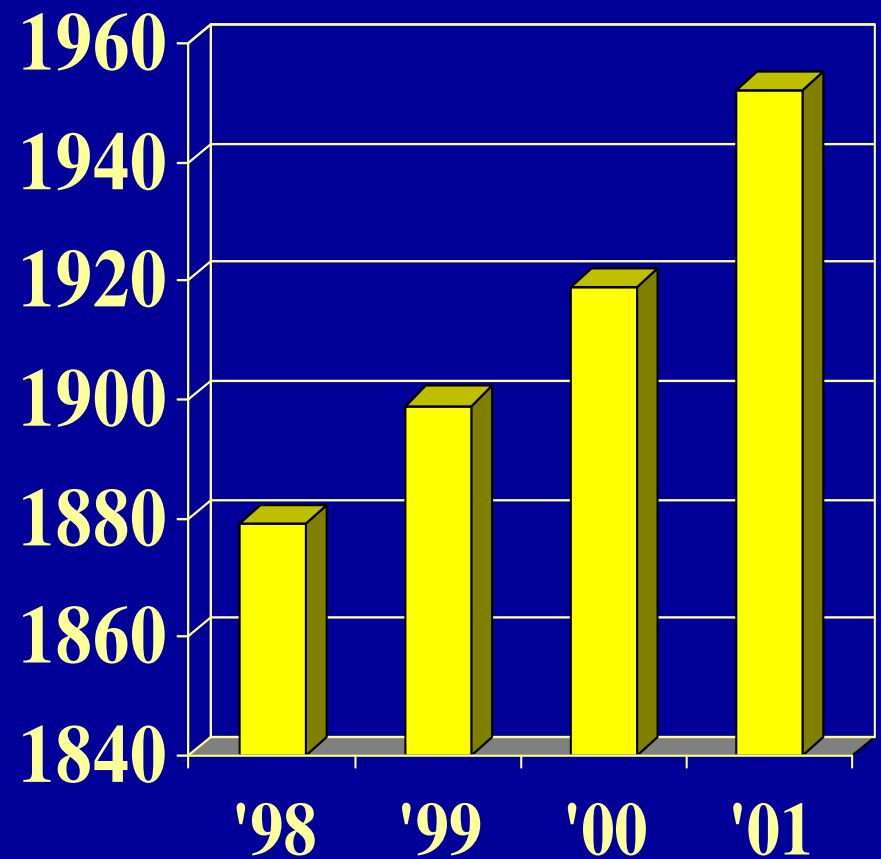

Outstanding Faculty

National Science Foundation CAREER Awards

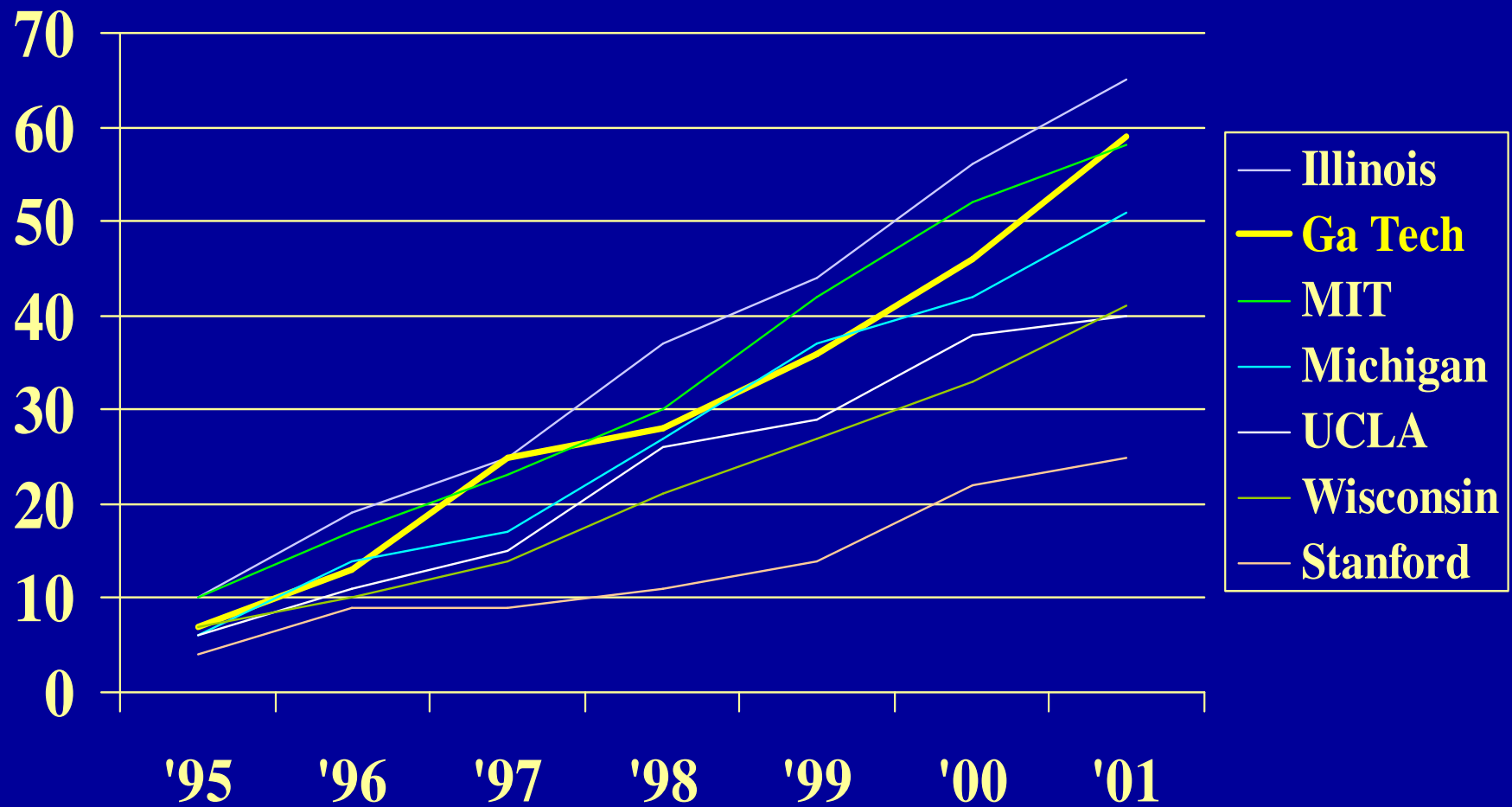

Leading Interdisciplinary Research



Biotechnology

Nanotechnology

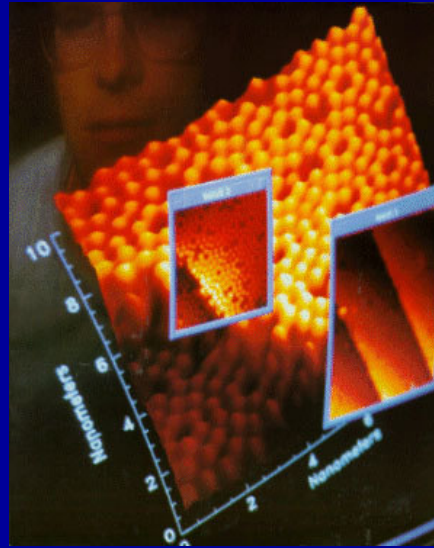

Sustainable Technology

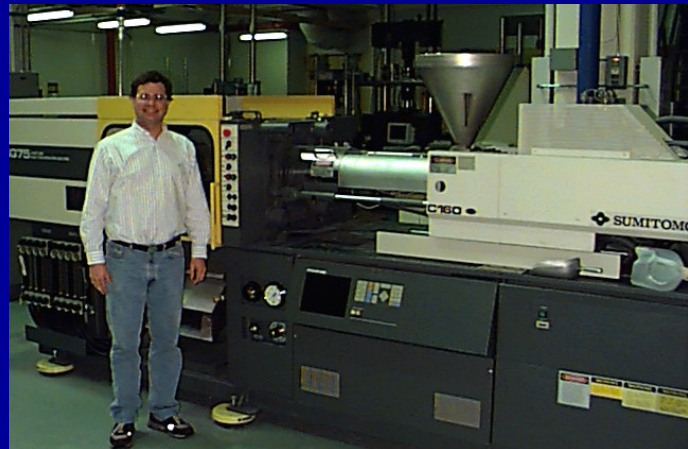

Manufacturing



Advanced Communications

Over 80 Interdisciplinary Centers and Institutes

Some examples –

- Georgia Tech Research Institute (GTRI)



- Reports to the Office of the President
- 800 employees
- \$100 million annual research budget
- Self-supporting budget, but facilities owned and maintained by Georgia Tech
- Primary mission research; no teaching expectations

Over 80 Interdisciplinary Centers and Institutes

Some examples –

- Georgia Tech Research Institute (GTRI)
- National Electric Energy Testing, Research & Applications Center (NEETRAC)

- Reports to dean of College of Engineering
- Test facilities, R&D staff of Georgia Power Company Research Center merged into Georgia Tech in 1996
- \$4.5 million annual research budget
- 23 researchers, 6 support staff
- Supported by affiliate fees, several fee levels
- Mainly academic faculty, graduate students

Over 80 Interdisciplinary Centers and Institutes

Some examples –

- Georgia Tech Research Institute (GTRI)
- National Electric Energy Testing, Research & Applications Center (NEETRAC)
- Manufacturing Research Center (MARC)



- Reports to Vice Provost for Research
- 20 staff plus 52 faculty associates
- Works with industry partners on projects from 3 months to 3 years in length
- 5 research programs, education program offering graduate-level certificate in manufacturing with international option
- \$6 m annual research budget

Over 80 Interdisciplinary Centers and Institutes

Some examples –

- Georgia Tech Research Institute (GTRI)
- National Electric Energy Testing, Research & Applications Center (NEETRAC)
- Manufacturing Research Center (MARC)
- Petit Institute for Bioengineering and Bioscience (IBB)



Parker H. Petit Institute for
Bioengineering and Bioscience

- Reports to Vice Provost for Research

- Partnership with Emory University
- Home to NSF National Center of Excellence for Tissue Engineering
- 25 researchers; 20 administrative staff ; 42 faculty associates
- Research (\$10 m a year) and academic degrees
- \$11 million endowment
- Industry advisory board; affiliate fees

Innovative Facilities



Life Sciences and
Technology Complex



Klaus Advanced
Computing Technology



Technology
Square

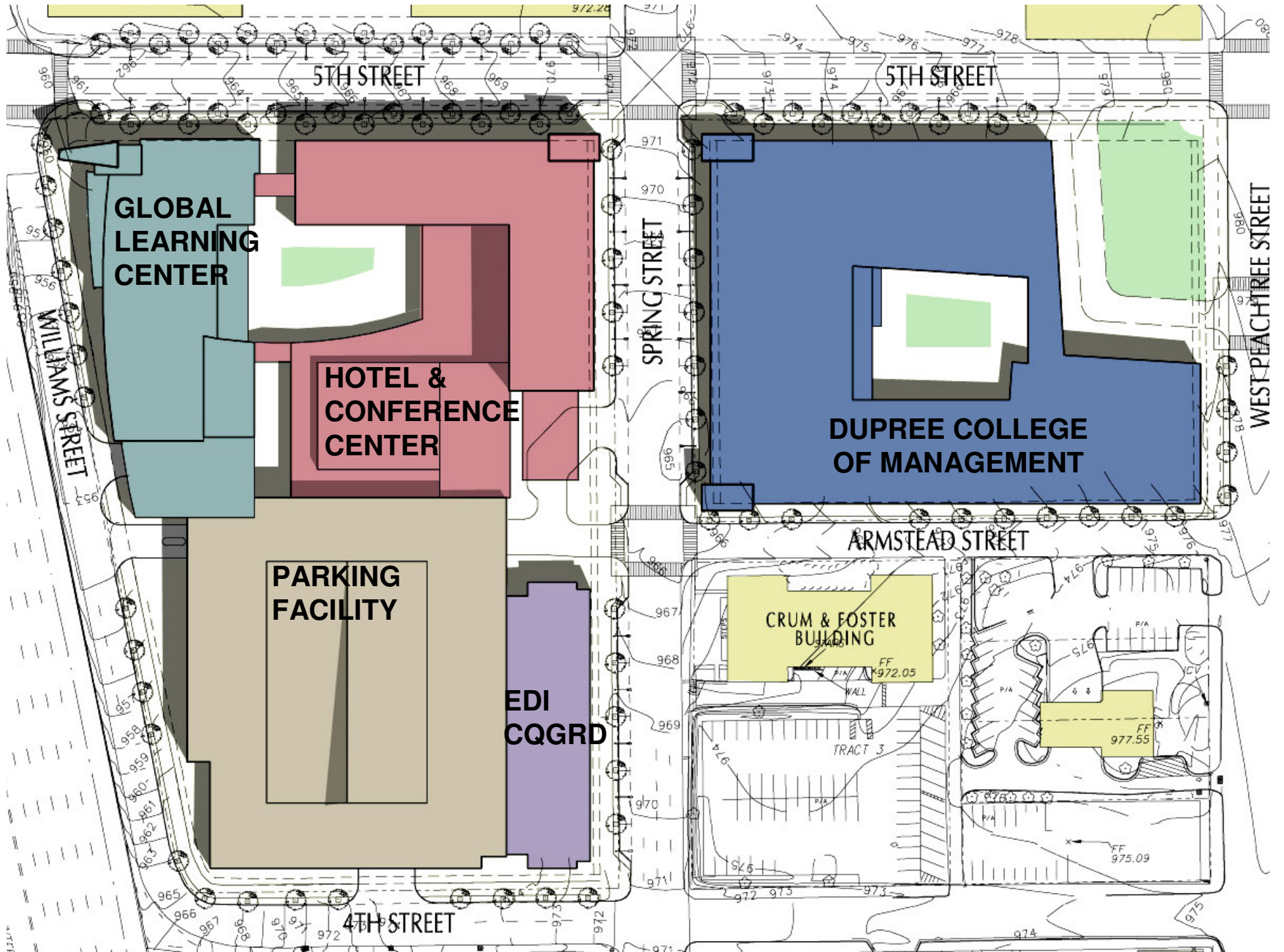

An IPST Within Georgia Tech: Opportunities

- Enhanced collaborative research
- Expanded economic development role
- More flexible educational options for students
- Traditional academic home for faculty
- Provides increased opportunity for international outreach
- State support for basic operations
- Reduced cost by elimination of duplicative administrative functions

An IPST Within Georgia Tech: Challenges

- Converting IPST from a culture of small private institution to role as part of large public institution
- Developing the case for merger with Tech faculty
- Insuring paper industry does not lose its enthusiasm for IPST
- Assuming positive early merger experience, ensuring positives hold for the long run
- Securing financial and political support from state

Issues for Discussion

- Academic and advisory issues
 - Integration of IPST faculty
 - Integration of graduate students
 - Role of IPST Board of Trustees
 - Sustaining research funding and interactions with paper industry
- Human resources and administrative integration
- 10th and 14th Street facilities
- Herty Foundation relationship

Financial Considerations

- Continuing financial support by industry
- Future use of endowment funds
- State funding for teaching mission and building operations and maintenance
- Access to equipment and research matching funds
- Savings from elimination of duplication of services

Possible Model for Merger

- IPST becomes one of Georgia Tech's Institutes
- Reports to the Office of the President
- IPST degree option formalized by BOR
- Faculty absorbed either on tenure track or as research faculty
- Board of Trustees continues in modified role
- Endowment folded into GTF restricted category

Hoops to Jump Through

- Regents acceptance of the idea
- Governor approves merger and commits to increment of funding
- Legislative leaders brought on board and assurances obtained for funding appropriation
- Regents agree to pass on funding increment