

*The University of Kansas*



# *The Preservation of a Campus: a Cooperative Grant Project with a Digital Product*

*Deborah Ludwig, Librarian*

Interim Director, Scholarly Digital Initiatives

Director of Enterprise Academic Services

Information Services / Information Technology

*Becky Schulte, Librarian*

University Archivist

*Electronic Resources & Libraries, Atlanta GA - 24 February 2007*



# Copyright Statement

*Copyright, by the authors 2006. This work is the intellectual property of the authors. Permission is granted for this material to be shared for non-commercial, educational purposes, provided that this copyright statement appears on the reproduced materials and notice is given that the copying is by permission of the author. To disseminate otherwise or to republish requires written permission from the authors.*



# University Profile

- State-funded institution
- Carnegie Research I (Doctoral Extensive)
- 85 academic departments
- 90 research centers, laboratories, and units
- 29,272 students
- 2,200 faculty



# KU: Information Services Organization

- Libraries and IT are part of the same organization.
- Reports Vice-Provost of Information Services or (CIO)
- Includes 3 Divisions:
  - Libraries (7 total)
  - Information Technology & Network/Telecomm for Campus (no Library IT)
  - Networking and Telecommunications

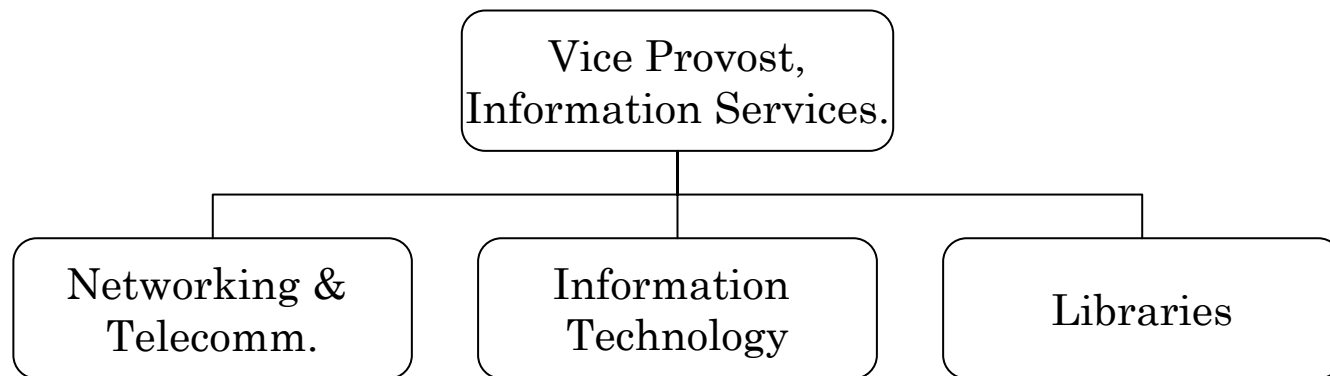

# Getty Foundation Campus Heritage Grant Initiative

- 71 universities and colleges
- Five years, 2002-2006
- Program purpose – *“assist colleges and universities in the United States to manage and preserve the integrity of their significant historic buildings, sites and landscapes.”*
- UC-Davis, Tuskegee, Wisconsin-Madison, U.S. Naval Academy in Annapolis, MD



# The KU Project – Campus Units Involved

- **Design and Construction Management**
  - Grant recipient and primary investigator
  
- **University Archives**
  - Content
  - Historical Knowledge
  
- **Digital Initiatives, a program of Information Services**
  - Consulting for content development
  - Technology support



# Linking the Complementary Missions of Content Creators and Technologists

- Four distinct groups of people working together
  - Staff from Design & Construction Management (DCM)
  - DCM's external consultants
  - Staff from University Archives & Spencer Research Library
  - Staff from KU Digital Initiatives program
- First opportunity to work together as a team.
- Weekly meetings helped facilitate communication
- Archives & DI worked closely with DCM project and technical staff
- DCM facilitated the work of their external project consultants.





# University of Kansas Historic Preservation Master Plan

- Lawrence, Kansas – historical significance
  - Oregon Trail
  - New England Emigrant Aid Society
  - Bleeding Kansas
  
- KU campus – historical significance
  - Geography
  - Buildings and Landscape
  - Cultural Institution



# Getty Grant – KU Project Purpose

To create a **Historic Preservation Master Plan**  
for the University of Kansas

“help coordinate land use, inform landscape plans  
and identify significant features to be preserved  
even as development pressure and redevelopment  
continues on campus”

Grant amount is \$130,000



# Getty Grant – Digital Initiatives Purpose

To consider the needs for digital preservation of the  
digital result of the  
**Historic Preservation Master Plan**

- Digital Initiatives involvement was the result of DCM contact with the University Archives.



# Quick Tour – Image Highlights

A sampling of the rich imagery that will be included in the resulting digital image collection and report.



# Sample Photo (Front) 1928 Automobiles



# Sample Photo (back)

0/34/1  
Automobiles  
1928

Jayhawk Blvd. looking  
~~west~~ from Watson

Property of  
University of Kansas  
Archives

ALUMNI ASSOCIATION  
UNIVERSITY OF KANSAS

East face

1928 on 8

Campus drive  
between Class

41395  
PG. 93  
POST photo  
ID. —

001168

# Landscape feature (bench) 1950's





# Landscape, 1969 (human interest)





# Ariel Map, 1950s (note proposed building)

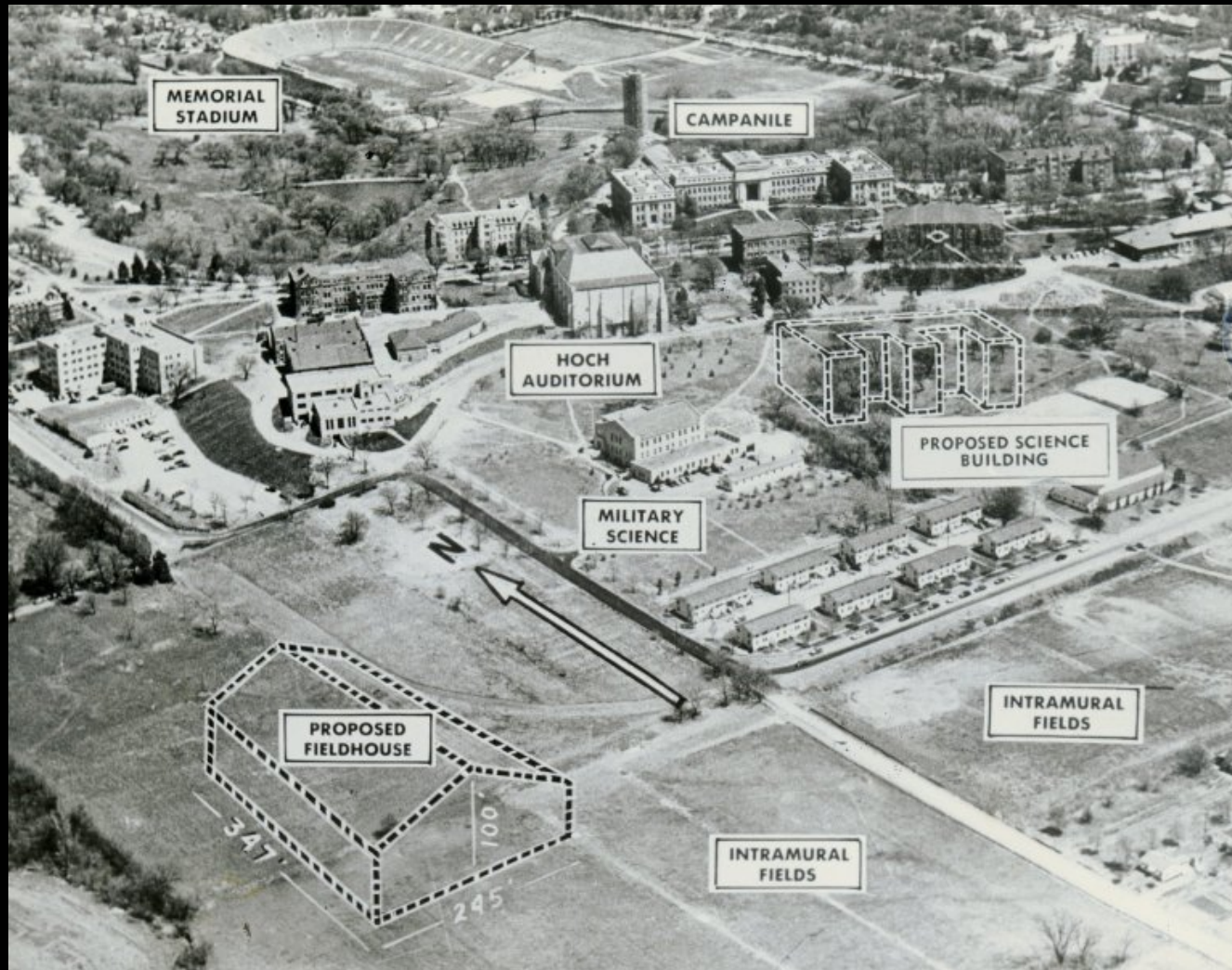

# Campus Map, 1892

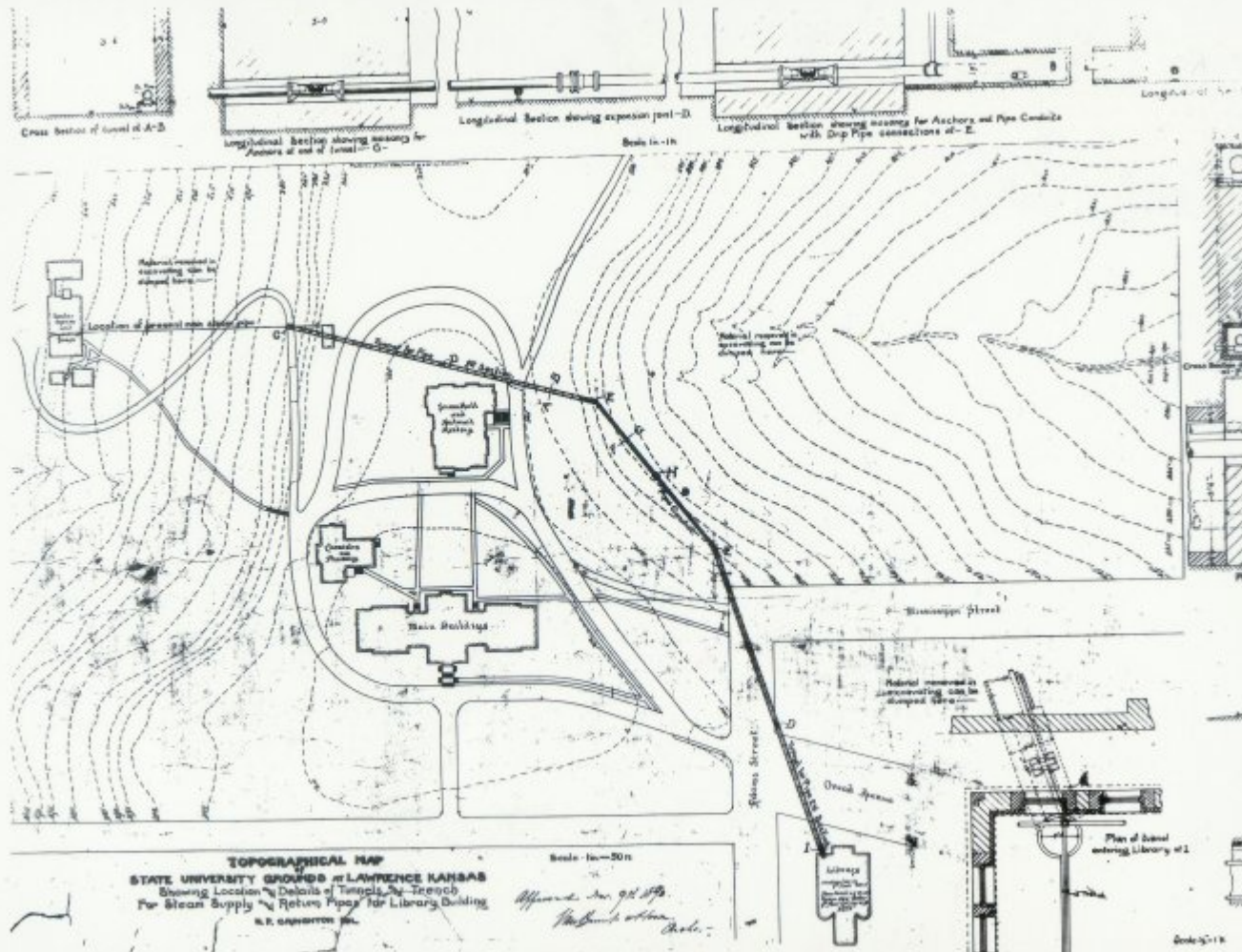

# Campus Map 1892 (Back)

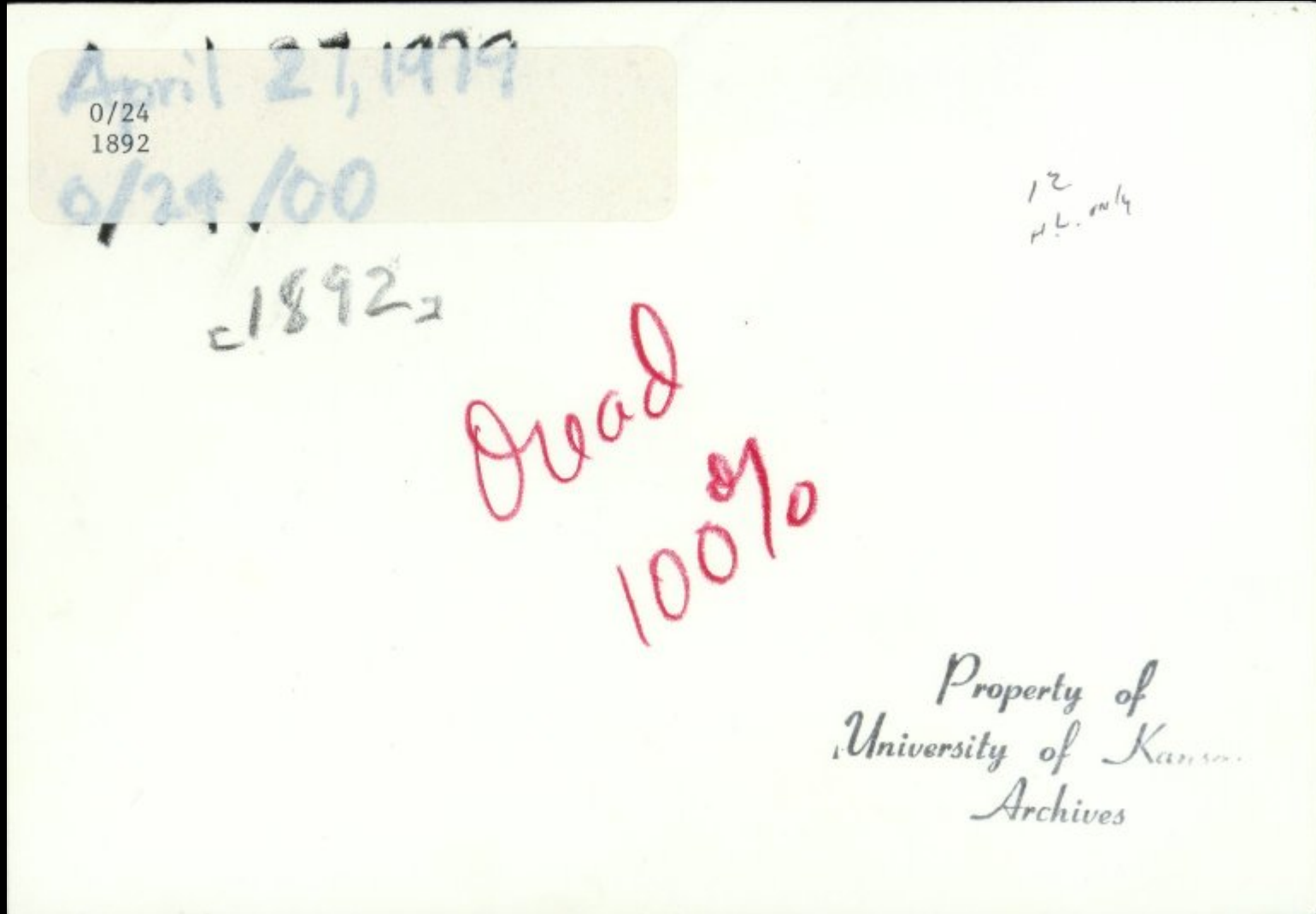



# Campus Map, 1904 –Site of New Gymnasium

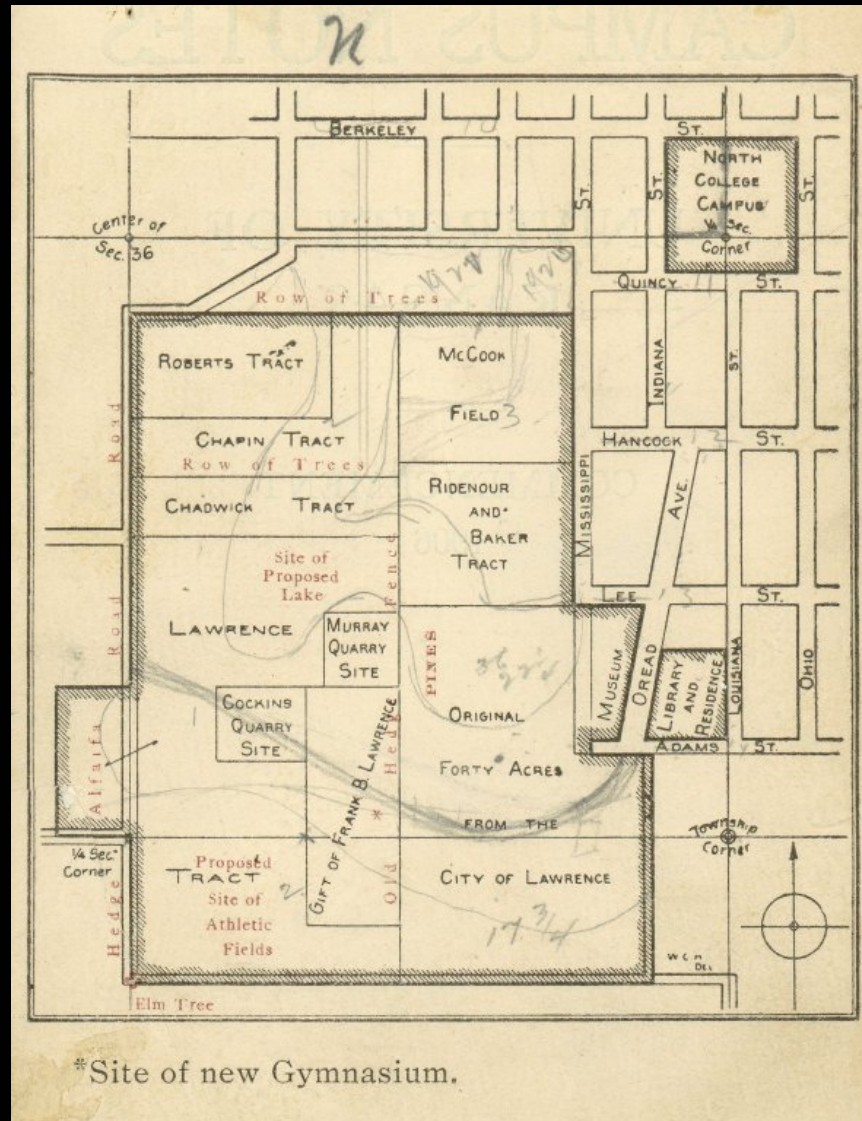

# Document, 1904

TABLE SHOWING AREA OF THE COMPONENT PARTS  
OF THE CAMPUS

<hr/>					
Original Forty Acre Site, from Chas Robinson - Apr. 25 '63	40.0 acres				
North College Campus, east half	4.3 acres,	} from City L = Dec. 3 '66 = $\frac{5}{4}$ a.			
	west half 3.7 acres,	" Jas H Lane - June 16 '65 = $2\frac{3}{4}$ a.			
			. . . . .	8.0 acres	
McCook Field, from John J Mc-Cook . . . . .				12.5 acres	
Museum Block, . . . . .				2.5 acres	
Library and Residence Lots, (Spencer) L Bullene 4/12/93				3.0 acres	3500.
Mississippi Street, vacated by City, . . . . .				1.2 acres	
Lawrence Gift, from Frank B Lawrence - Nov 26. 1904 . . . . .				10.0 acres	—
Lawrence Tract, " . " : " . " : " : " contract.				41.2 acres	1800.
Murray Quarry Site, from Dora C Renn, Mar. 8. '05 . . . . .				2.5 acres	600.
Cockins Quarry Site, from L I Blake - Apr. 18. '05 . . . . .				3.0 acres	750.
Chadwick Tract, from A Henley - Mar. 21. '05 . . . . .				6.9 acres	750.
Chapin Tract, . from Olin Templing - June 9. '05 . . . . .				10.0 acres	2100.
Roberts Tract, from C W Roberts, Mar. 25. '05 . . . . .				9.0 acres	4750.
Ridenour and Baker Tract, from R & B - Apr. 17. '05 . . . . .				11.9 acres	3000.
Adams Street and Oread Avenue, vacated by City				1.9 acres	
Total, . . . . .				163.6 acres	
<hr/>					



# Campus Map, 1919

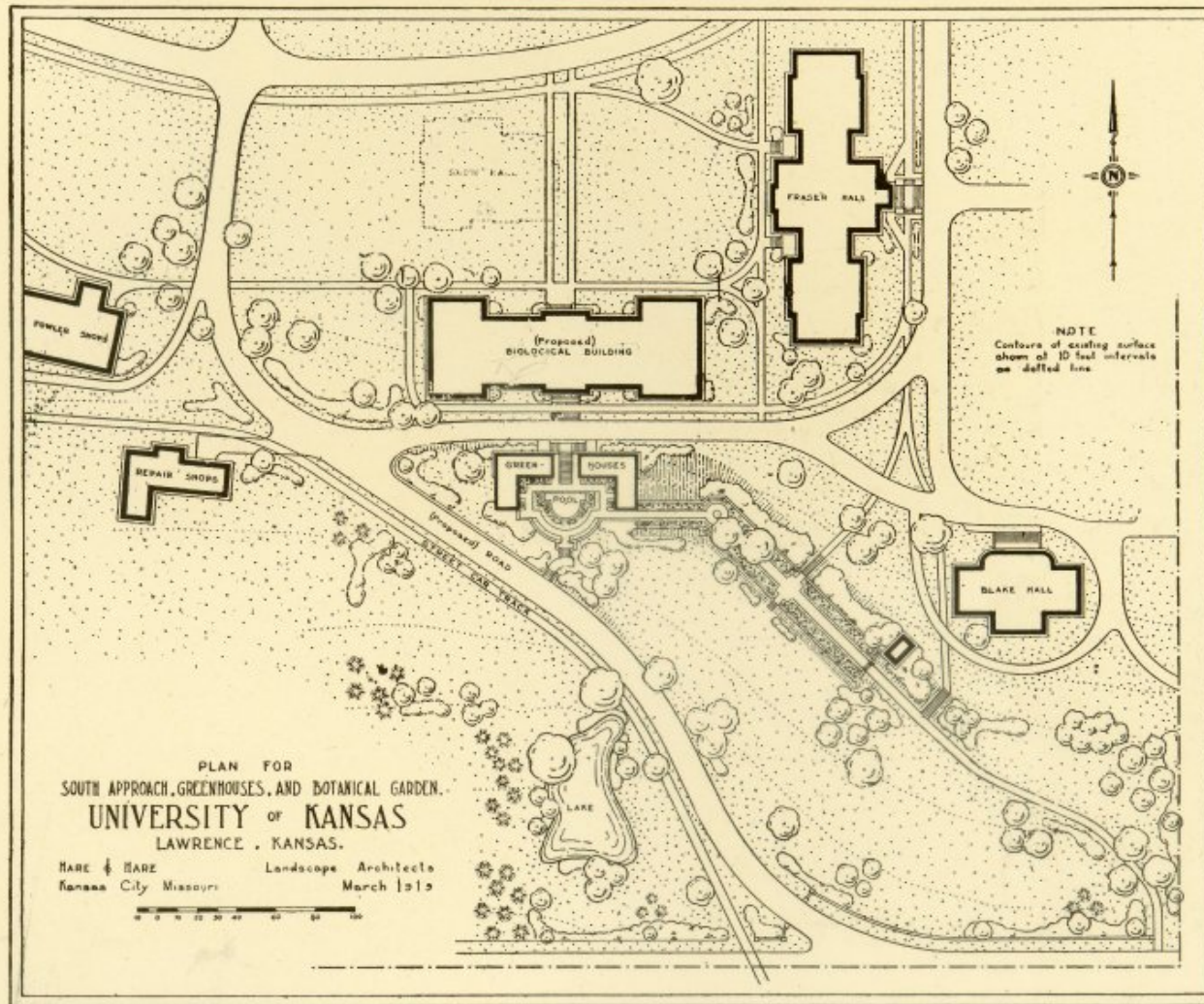

THE PROPOSED SOUTH APPROACH, GREEN HOUSES AND BOTANICAL GARDENS FOR THE UNIVERSITY OF KANSAS

# Campus Map 1951

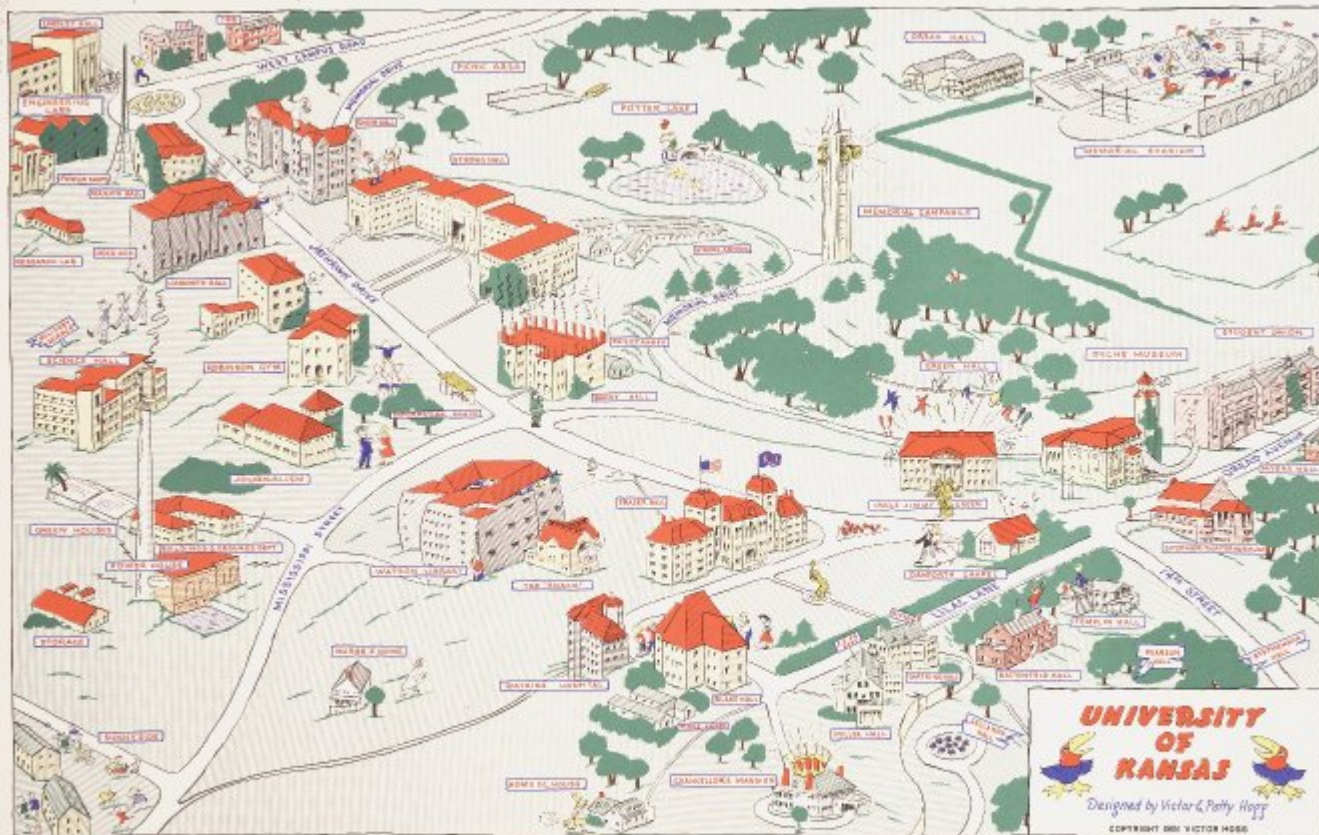



# Photo and DCM metadata to be joined





# Photo + temporary metadata (LUNA Insight)



Descriptive Data



Information File Data

KU DCM image review

Collection: (KU) DCM image review

Identifier: ksrl.Id2688o5.93\_036a.tif

Title: Hill, p.036a

Source: University Archives, Kenneth Spencer Research Library, University of Kansas

Relation: On the hill : a photographic history of the University of Kansas / compiled by Virginia Adams ... [et al.]; with a foreword by Raymond Nichols and introductory essay by Roy E. Gridley. 2nd ed., rev. Lawrence : University Press of Kansas, c1993



*Whitely*



De Lee's Art Gallery,  
South Tennessee St.,  
Levittown, Pa.







# Linking the Complementary Missions: Workflows

- Archives is lynch pin between DCM and Digital Initiatives delivering requested content to DCM for evaluation & then transferring the selected content to Digital Initiatives.
- Workflows & processes used
  - Direct access to materials in archives
  - Form that travels with materials from archives to digitization
  - Digitization, scan both sides of photos
  - Creation of ID and transfer to *temporary* digital repository
  - DCM will create metadata for the final repository.





# Specific Goals of the Digital Project

## (a formal proposal)

1. To support Design and Construction Management with consulting, resources, standards, services, and tools as it creates a preservation master plan to guide future preservation and development on the historic campus.
2. To ensure that the complementary missions of technologists and content providers ("curators") are clearly linked and understood.
3. To create a model project for presentation of web-based documentation that can be adapted and used with other similar campus projects.



# Digital Preservation – A Model Project

(Goal 3)

- **Preservation** - create something we believe to be preservable in a digital form:
  - Moving *upstream* to consider preservation at creation
  - Repositories used (collocation versus trusted)
  - Standards employed
  
- **Interoperability of tools** – the report architecture
  
- **Reusability** of approach





# Expected Outcomes for Digital Product

1. Digital *report* from the grant that will be preserved.
  - Report text deposited in KU Scholarworks (Institutional Repository).
  - Report images (master & access)
2. An *innovative interactive digital product* that will evolve over time, serving as a source for future research by faculty, staff, students (not necessarily preservable.)



# Support for DCM, Consulting

## ➤ Report Architecture (XML-based)

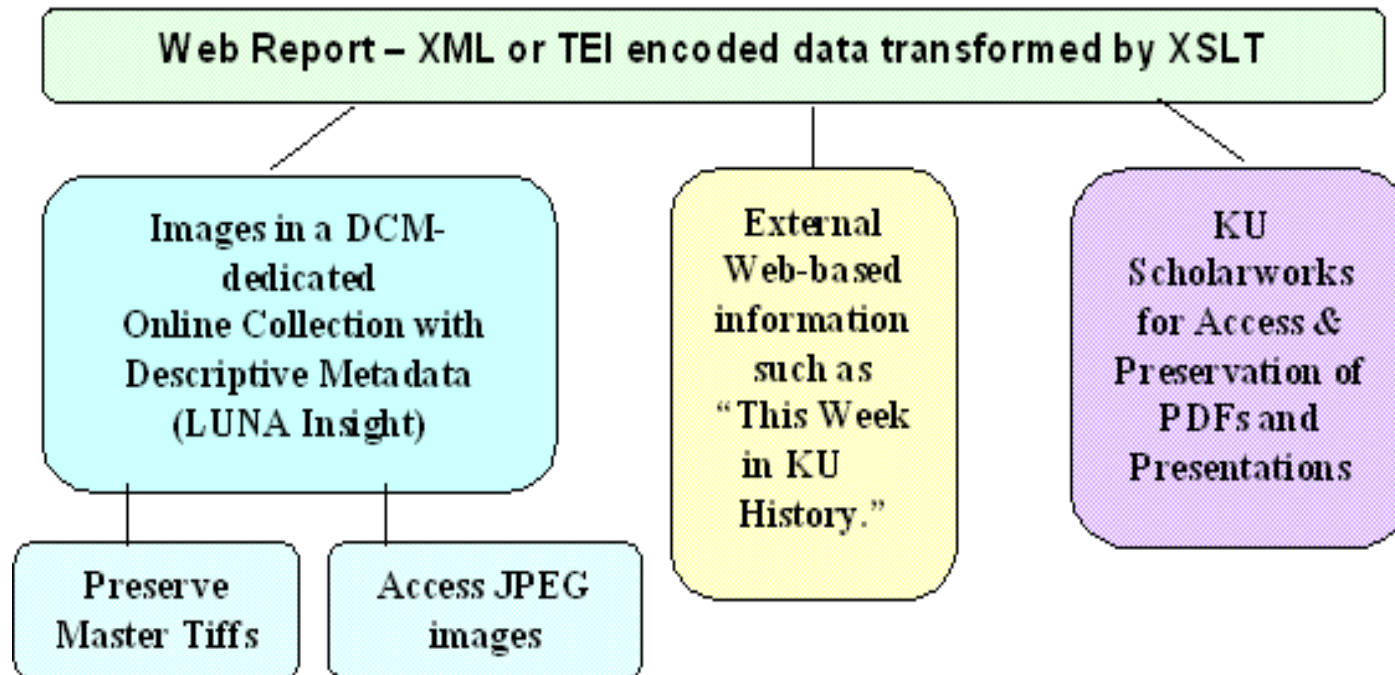

# Support for DCM, Consulting

(Goal 1)

## ➤ Report Architecture (XML-based)

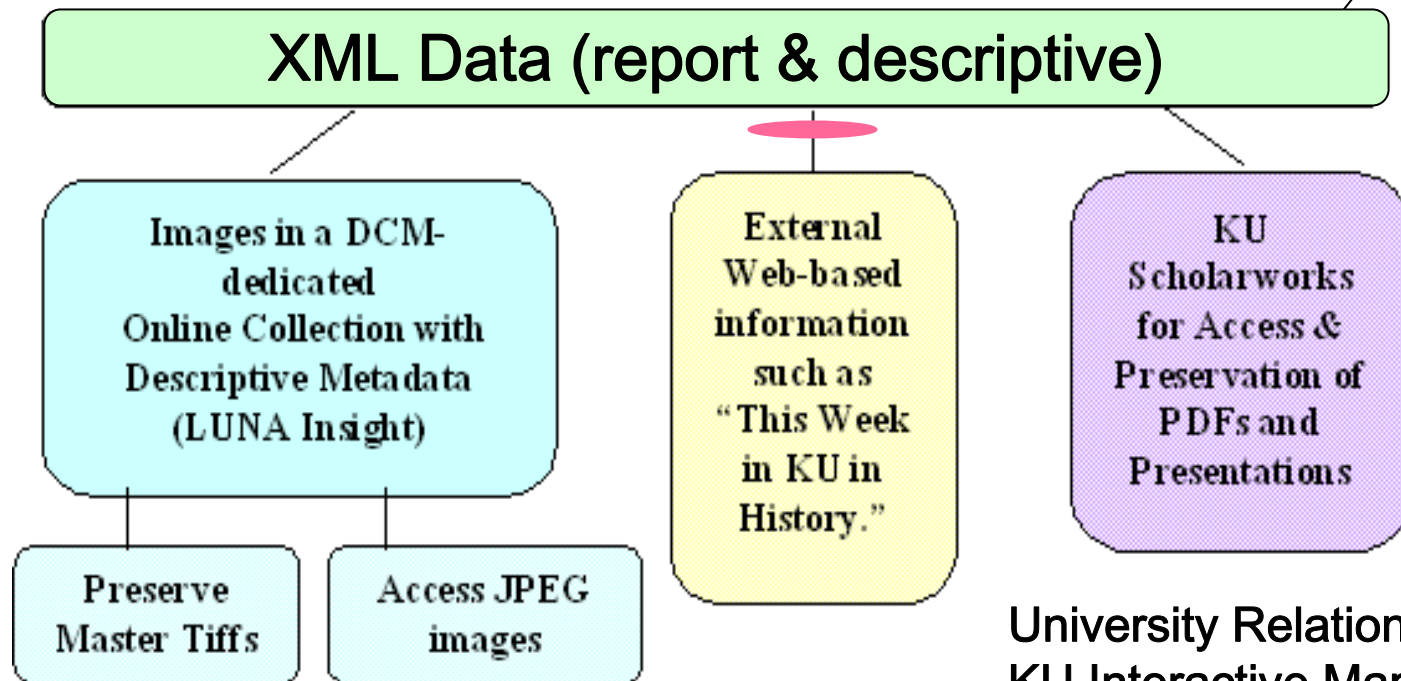

University Relations  
KU Interactive Map  
<http://www.maps.ku.edu/>





# University Relations Project – Interactive Map

## Interactive Lawrence Campus Map

[Return to Maps & Directions](#)

[Search](#) | [Buildings](#) | [Departments](#) | [Help](#)

Add historical layers?

#

517 W. 14th St. Art Studios ()

A

Adams Alumni Center (AAC)

Allen Fieldhouse (AL)

Allen Fieldhouse Parking Garage ()

K.K. Amini Scholarship Hal (KKAH)

Margaret Amini Scholarship Hall (MAH)

Anderson Family Strength and Conditioning Center (ASC)

Anschutz Library (ANSL)

Anschutz Sports Pavilion (ANSP)

Arrocha Ballpark ()

Art & Design Building (A&B)



# Support for DCM, Consulting

## *Google Map XML – Possibilities*

```
<?xml version="1.0" encoding="iso-8859-1" ?>
- <buildings>
- <building name="517 W. 14th St. Art Studios" abbr="" address="517 W. 14th St." city="Lawrence" state="KS" zip="66044-3401"
  lat="38.95790709902157" long="-95.2410364151001" offsetx="7" offsety="5" minzoom="15" maxzoom="17"
  icon="w14th_artstudios" width="23" height="21" sort="#">
  <description bgaddress="" />
- <departments>
  <department name="" web="" sort="" />
</departments>
- <types>
  <type>Academic</type>
</types>
<hours />
</building>
- <building name="Adams Alumni Center" abbr="AAC" address="1266 Oread Ave." city="Lawrence" state="KS" zip="66045-3169"
  lat="38.96028476559292" long="-95.24245262145996" offsetx="15" offsety="64" minzoom="15" maxzoom="17" icon="adams"
  width="86" height="95" sort="a">
  <description bgaddress="http://www.buildings.ku.edu/a.shtml#aac">The red-brick building opened in 1983, the centennial
    of the KU Alumni Association. It offers reception and meeting rooms; lounge, library and activity rooms; and offices for
    administrative, programs, publications and records staff members.</description>
- <departments>
  <department name="" web="" sort="" />
</departments>
- <types>
  <type>Administrative</type>
  <type>Services</type>
  <type>Library</type>
</types>
```



# Support for DCM, Standards

- **Image standards** [http://kudiglib.ku.edu/planning/dli\\_standards.rtf](http://kudiglib.ku.edu/planning/dli_standards.rtf)
  - Masters = uncompressed TIFF file, captured in 24-bit color, at a resolution of 600 dpi.
  - Access or derivative copies = JPEG or JPEG2K images derived from the TIFF file, which will allow a reasonable download time for the average Web-based user.
- **Metadata.** DCM has a set of database fields and is finalizing a custom metadata scheme to reflect project needs in describing imaging. Also using controlled vocabulary.
  - Season
  - Event (Football, parade, homecoming, etc)
  - Orientation of buildings
  - Landscape zone
  - Spatial data
- **XML** for text of report





# Support for DCM, Standards METADATA & Controlled Vocabulary (Goal 1)

Archive Record Data:

Repository:	<input type="text"/>	Group/Individual Responsible for Image:	
Repository Id:	<input type="text"/>	Creator:	<input type="text" value="Select Creator..."/> or enter your own: <input type="text"/>
Source:	<input type="text"/>	Creator Role:	<input type="text" value="Select Creator Role..."/> or enter your own: <input type="text"/>
Copyright:	<input type="text"/>		
Additional comments:	<input type="text"/> (255 character limit)		



# Goal 1 – Support for DCM, *Standards* METADATA

Select the features associated with this image:

Art:

Select Feature...

Add Feature to This Image

Buildings:

Select Feature...

Add Feature to This Image

Landscapes:

Select Feature...

Add Feature to This Image

Markers:

Select Feature...

Add Feature to This Image

Memorials:

Select Feature...

Add Feature to This Image

Misc Features:

Select Feature...

Add Feature to This Image

(Can't find the feature you want?

Follow [this link](#) and add the feature to the database, then

[Click to See New Feature](#))



# Support for DCM, Tools

(Goal 1)

- Google Maps javascript (under consideration)
- Metadata Collection in Custom Database + Web front end
- BASECAMP for shared project management & communication
- LUNA Insight for building image collections
- eXtensible Text Framework (CDL project) for XML report
  - <http://www.cdlib.org/inside/projects/xtf/>
- BESafe (dark archive for master images)



# Basecamp Project Management

*The University of Kansas*

University of Kansas, Digital Initiatives Program

Logged in as Deborah Ludwig (Log-out) HELP

DashboardTo-DosMilestones

PeopleAccountTemplatesSettings

Late Milestones

94 days late: [Metadata Schema Determined](#) [KU DCM | KU DCM - Getty Grant Project | Holly Mercer]

Latest activity

KU DCM — KU DCM - Getty Grant Project

MESSAGE	27 Nov	<a href="#">Getty Trip to UMKC Archive</a>	posted by	Peggy L.
FILE	10 Nov	<a href="#">Data Scheme_01.xls</a>	uploaded by	Peggy L.
MESSAGE	10 Nov	<a href="#">Draft for Metadata Scheme</a>	posted by	Peggy L.
MILESTONE	30 Oct	<a href="#">Controlled Vocabulary Determined</a>	completed by	Holly M.
FILE	17 Oct	<a href="#">Determining Copyright Status.doc</a>	uploaded by	Sarah G.
MESSAGE	17 Oct	<a href="#">copyright attachment</a>	posted by	Sarah G.
MESSAGE	17 Oct	<a href="#">kessler</a>	posted by	Sarah G.
FILE	11 Oct	<a href="#">BestPracticesTable 2.doc</a>	uploaded by	Sarah G.
MESSAGE	11 Oct	<a href="#">Imaging Standards</a>	posted by	Sarah G.
FILE	2 Oct	<a href="#">Overview of Image Repositories Steps.pdf</a>	uploaded by	Deborah L.
MESSAGE	2 Oct	<a href="#">Diagram of Image &amp; Metadata creation ...</a>	posted by	Deborah L.
MESSAGE	2 Oct	<a href="#">File Share on FMIS2 server.</a>	posted by	Joe F.
MESSAGE	2 Oct	<a href="#">KU/Getty Campus Conservation Plan</a>	posted by	Peggy L.
FILE	26 Sep	<a href="#">Minimal Inscribe Record.doc</a>	uploaded by	Deborah L.
MESSAGE	26 Sep	<a href="#">LUNA Insight access resolved &amp; Metada...</a>	posted by	Deborah L.
MILESTONE	26 Sep	<a href="#">LUNA Insight Repository built for ima...</a>	completed by	Deborah L.
MILESTONE	26 Sep	<a href="#">Metadata Schema Determined</a>	assigned to	Holly M.

digital initiatives

Your projects

Create a new project

KU DCM

[KU DCM - Getty Grant Project](#)



file  
edit  
group  
data  
search  
print  
return  
help  
exit

by identifier  
by keywords  
by data fields  
show all

## KU DCM image review



automobiles, 1928 b  
ksrl.ua.0.24.1.autom  
University Archives



automobiles, 1928  
ksrl.ua.0.24.1.autom  
University Archives



Battenfeld Hall draw  
ksrl.ua.gradmagvol:  
University Archives

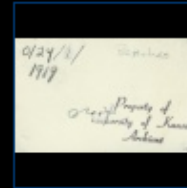

bench, 1919 back  
ksrl.ua.0.24.1.bench  
University Archives



bench, 1919  
ksrl.ua.0.24.1.bench  
University Archives



bench, 1920s back  
ksrl.ua.0.24.1.bench  
University Archives



bench, 1920s  
ksrl.ua.0.24.1.bench  
University Archives

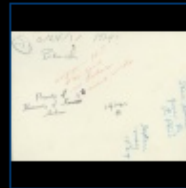

bench, 1929 back  
ksrl.ua.0.24.1.bench  
University Archives



bench, 1929  
ksrl.ua.0.24.1.bench  
University Archives



bench, 1950s back  
ksrl.ua.0.24.1.bench  
University Archives



bench, 1950s  
ksrl.ua.0.24.1.bench  
University Archives

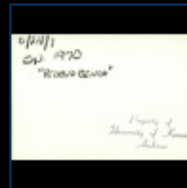

bench, 1970 back  
ksrl.ua.0.24.1.bench  
University Archives

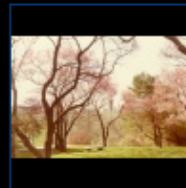

bench, 1970  
ksrl.ua.0.24.1.bench  
University Archives

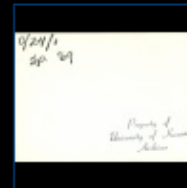

bench, Spring, 1969  
ksrl.ua.0.24.1.bench  
University Archives

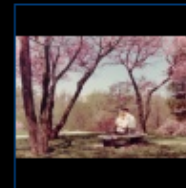

benchSpring, 1969  
ksrl.ua.0.24.1.bench  
University Archives

# eXtensible Text Framework (XTF) for Report

## ENCYCLOPEDIA *of* CHICAGO

[Entries](#) | [Historical Sources](#) | [Maps](#) | [Special Features](#) | [User's Guide](#)



Full  
List

### SEE ALSO

[Leisure](#)  
[Museums in the Park](#)  
[Waterfront](#)

### HISTORICAL SOURCES

ENTRIES : ADLER PLANETARIUM

### ENTRIES

[A](#)

[Adler Planetarium](#)

[Next](#)

## Adler Planetarium



LAKEFRONT MUSEUMS, 1947

Grunsfeld and opened in 1930 on a small island connected to the shore by a causeway. It was the first modern planetarium in the Western Hemisphere. During the [Century of Progress Exhibition](#) (1933–34) a million and a half people visited the planetarium and museum. Its unique position on [Lake Michigan](#) offered then, as it does now, the best view possible of the Chicago skyline.

The Adler Planetarium & Astronomy Museum was conceived in 1928 on a visit to Europe by Max Adler, a retired executive with Sears, Roebuck & Co. There he saw the newly invented Zeiss planetarium projector, which reproduced the night sky with unparalleled accuracy inside a domed theater. Upon his return, he donated a Zeiss projector to the people of Chicago, with money to build an edifice to house it. The landmark 12-sided building that resulted was designed by Ernst

Even before the planetarium opened its doors, Philip Fox, the Adler's first director, had persuaded Max Adler to purchase the famed Menzies Collection of historic scientific

# eXtensible Text Framework (XTF) for Report

## ENCYCLOPEDIA *of* CHICAGO

Entries|Historical Sources|Maps|Special Features|User's Guide



Full  
List



### INDEX : AUTHORED ENTRIES

A  
B  
C  
D  
E  
F  
G  
H  
I  
J  
K  
L  
M  
N  
O  
P  
Q  
R  
S  
T  
U  
V  
W  
X  
Y  
Z

Aa

A - Agr  
Agr - Alp  
Als - Amo  
Amo - Aon  
Apa - Arm  
Arm - Ath  
Aub - Avo

ACLU (see American Civil Liberties Union )  
AIDS (Acquired Immune Deficiency Syndrome)  
AMR Corp. (see American Airlines Inc. )  
AT&T (see Western Electric Co. )  
Abbott Laboratories  
Abolitionism  
Accounting  
Ace Hardware Corp  
Acme Steel Co.  
Acting, Ensemble  
Addison, IL  
Adler Planetarium  
Admiral Corp.  
Advertising  
Advice Columns  
Afghans  
African Americans  
Agnes Nestor and the WTUL  
Agrarian Movements  
Agricultural Journals  
Agricultural Machinery Industry  
Agriculture  
Air Quality

### INDEX

A

Full Index

Authored Entries

Historical Sources

Maps

Special Features



Authored Entries

# Summary - Lessons Learned

- The project should have started a year before – so that much of the “backroom” work would have already been done!
- A project like this is very labor intensive – staff support should have been written into the grant.
- Cooperation between campus groups brings added value.
- Transfer to archives of physical materials housed in DCM.
- Build on the model used to create future Archives & DI projects.
- Scholarly content can be found in unexpected places.
- Appreciation for a partner that brings a project manager to the table.





## For further information:

- Becky Schulte, [bschulte@ku.edu](mailto:bschulte@ku.edu)
- Deborah Ludwig, [dludwig@ku.edu](mailto:dludwig@ku.edu)

