

Integrated Planning

- Where We Are...
- Where We Are Going...
- Using Integrated Planning
To Get There...

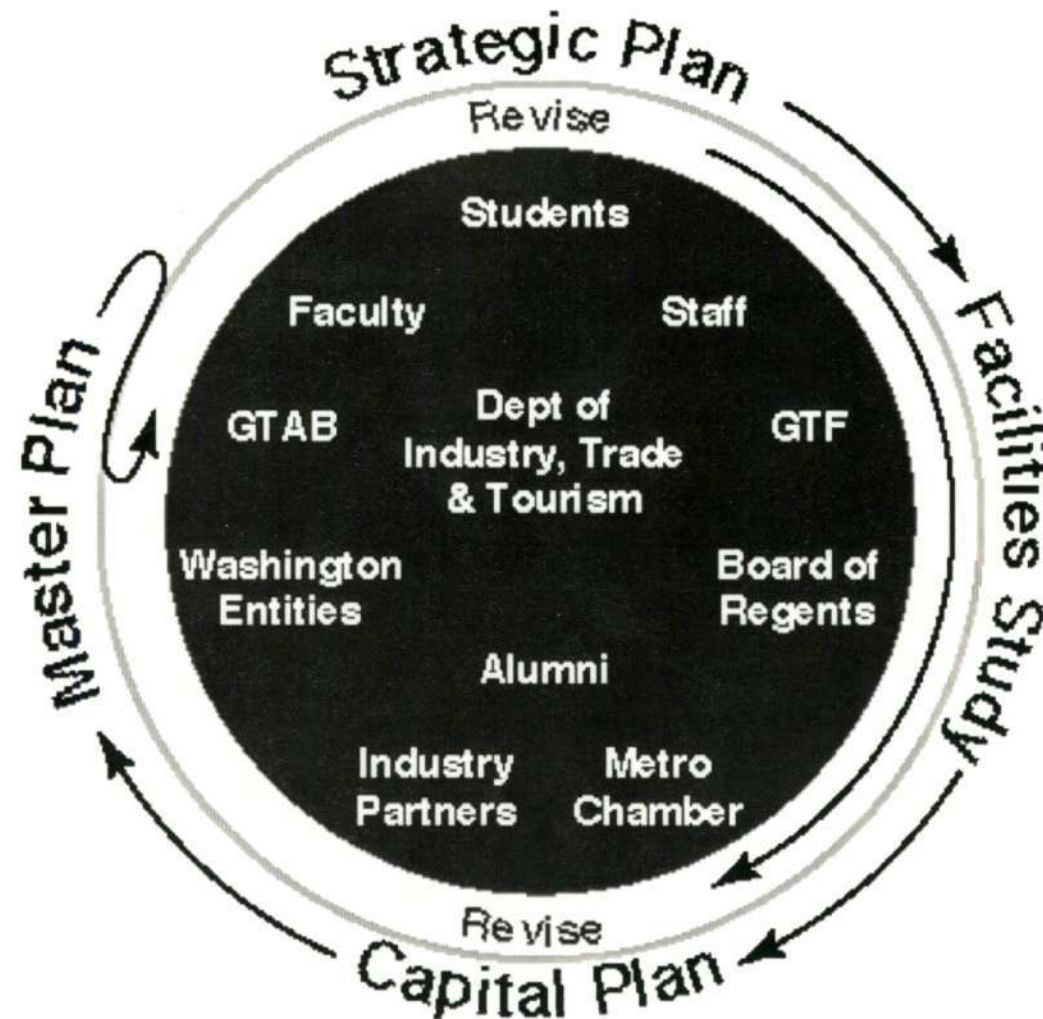

Integrated Planning



Georgia Tech Space Needs

Based on Facilities Study

- **GT's Average Square Footage / Faculty is 15% Below that of our Peers (50% Below in Computing)**
- **To Correct Existing Deficiencies:**
 - **1 Million Gross Square Feet**
 - **Estimated Cost \$207 Million**
- **To Meet Projected Requirements Regarding Enrollment Growth and Program Initiatives:**
 - **714,000 Gross Square Feet**
 - **Estimated Cost \$142 Million**

Major Capital Plans

- **Environmental Science & Technology Building**
- **Advanced Computing Technology Building**
- **Undergraduate Learning Center**
- **Student Recreation Center II**
- **Molecular/Materials Science & Engineering Building**
- **Executive / Continuing Education Conference Center**
- **Boggs Undergraduate Lab Renovation**
- **Bunger-Henry Building Renovation**

Integrated Planning Example I

The BEM Complex

- **Bioengineering and Biosciences**
- **Environmental Science & Technology**
- **Molecular and Materials Sciences and Engineering**

Advanced Computing Technology Building Specifics

- **Estimated Cost: \$40 Million**
- **Funding Sources: \$32 M State / \$8 M Donor**
- **170,000 Square Feet**
- **Meets Existing & Projected Enrollment Needs**
- **Consolidates and Expands Programs**
- **Provides Innovative Teaching & Research Space**
- **Enhances Integration of Academic Disciplines**
- **Supports Economic Development**

Undergraduate Learning Center Specifics

- **Expected Cost : \$44 Million**
- **Funding Sources: \$36 M State / \$8 M Donor**
- **225,000 Square Feet**
- **Creates a Comprehensive Learning Environment**
- **Blends Formal Academic Study and Campus Life**
- **Innovative Use of High Tech Classrooms**

Executive/Continuing Education Center Specifics

- **Expected Cost : \$40 Million**
- **Funding Sources: \$29 M State / \$11 M Payback**
- **Meet Rapid Growth in Demand for Continuing Education**
- **Use Advanced Technologies to Enhance Distance Learning**
- **Provide DuPree College with First Class Facilities for Executive Education**
- **Consider Joint Development with Hotel Operator**

Student Recreation Center II

Specifics

- **Estimated Cost: \$ 39 Million**
- **Funding Sources: \$10 M Donor / \$29 M Payback**
- **327,000 Square Feet of Classroom, Recreation and Office Space**
- **Expand Student Recreation**
- **Unify Aquatic Center and SAC as One Facility**
- **Ability to Host NCAA and Other Swimming Championships**
- **Enhance HPS Facilities**

Georgia Tech Today...

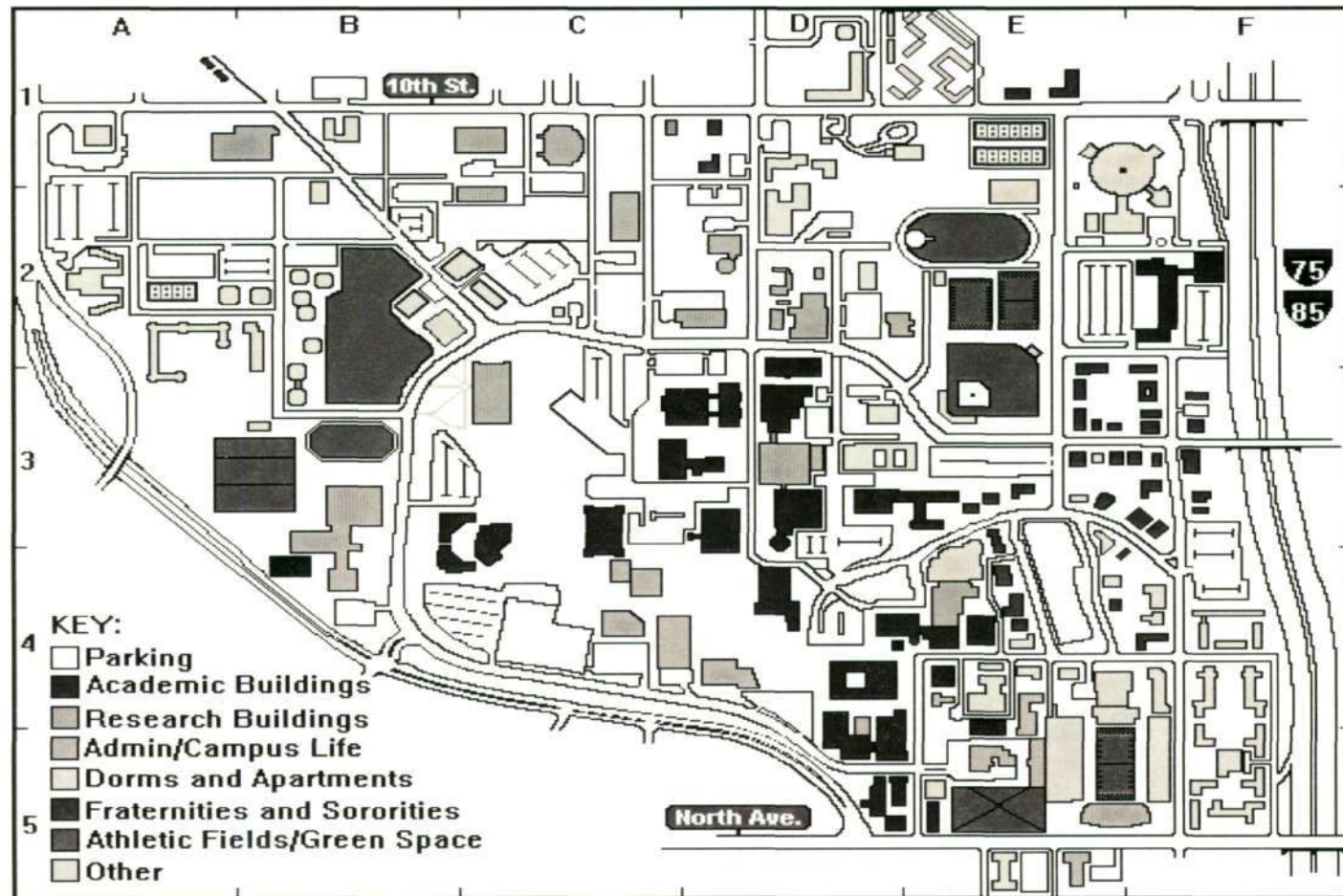

Circa. 1998

Georgia Tech The Future...

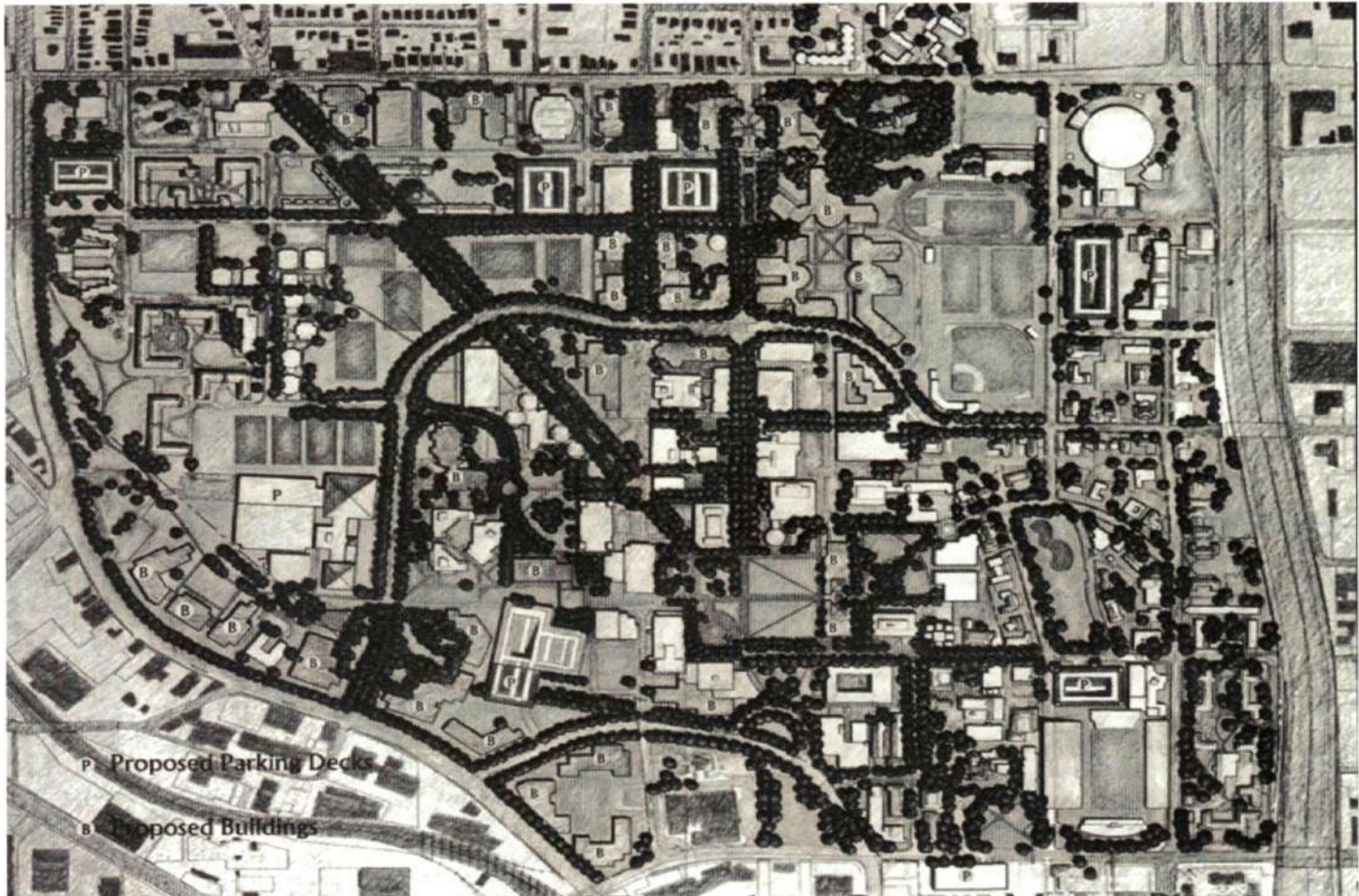

Circa. 2010

Georgia Tech The Past...

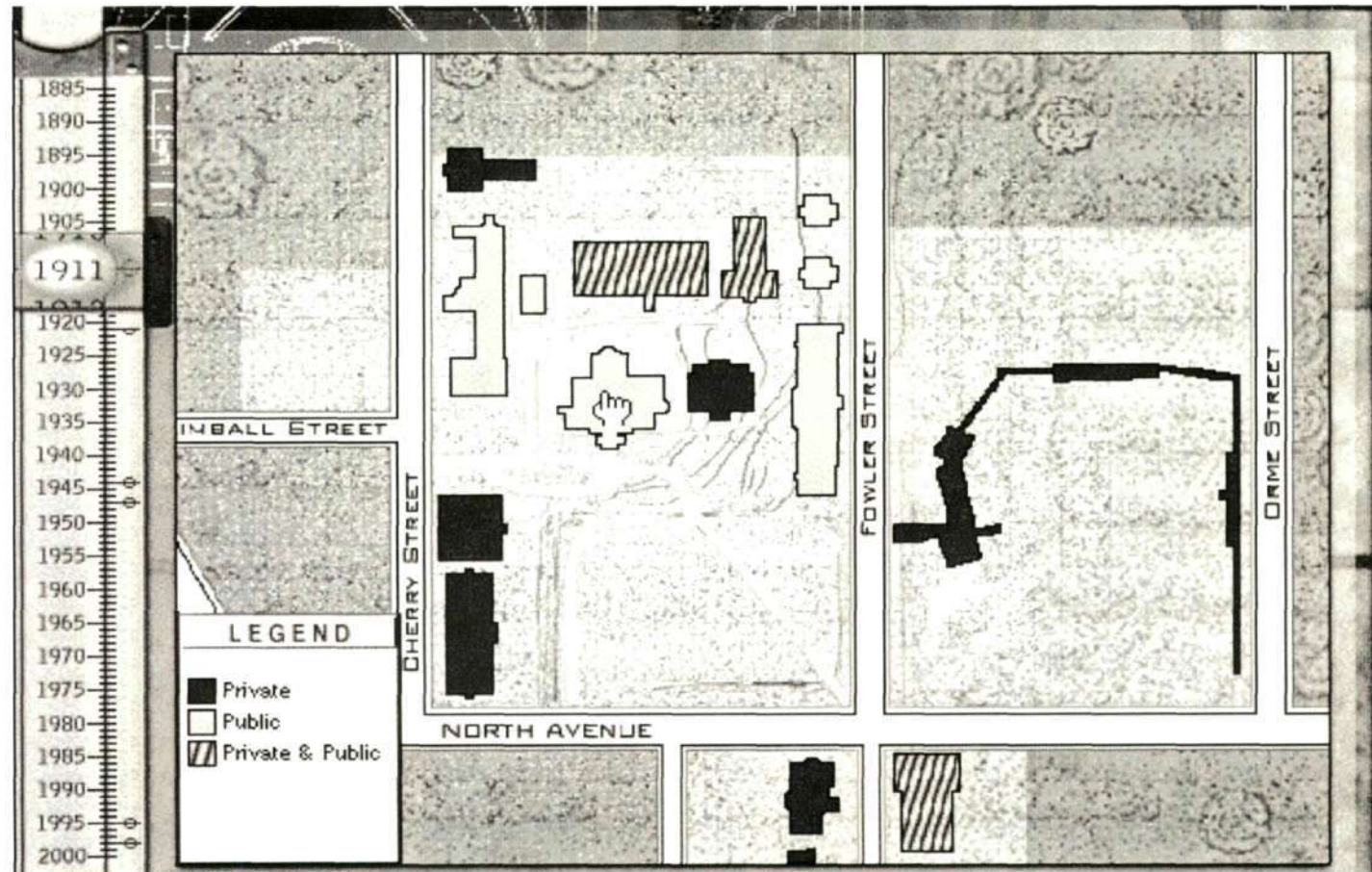

Circa. 1911

*Georgia Institute
of Technology*



- **“Georgia Tech is always mentioned as the expected primary source for these individuals...Those who would learn in the new building are needed in Georgia’s workforce now.”** -*Randy Cardoza*
- **“I urge you to accelerate your plans to increase the number of undergraduate and graduate students in this digital economy area.”** - *Sam Williams*
- **“If Georgia Tech does not take the lead in this initiative, we do not have an academic resource in our state that can accelerate the feeding of the supply chain.”** - *Jackie Ward*
- **“I very much endorse your efforts to expand Georgia Tech’s graduation rates in these disciplines, including construction of the Advanced Computing Technology facility.”** - *Allen Franklin*
- **“We have been pleased with the graduates of Georgia Tech that we have hired in this area and need more.”** - *Rick Ussery*

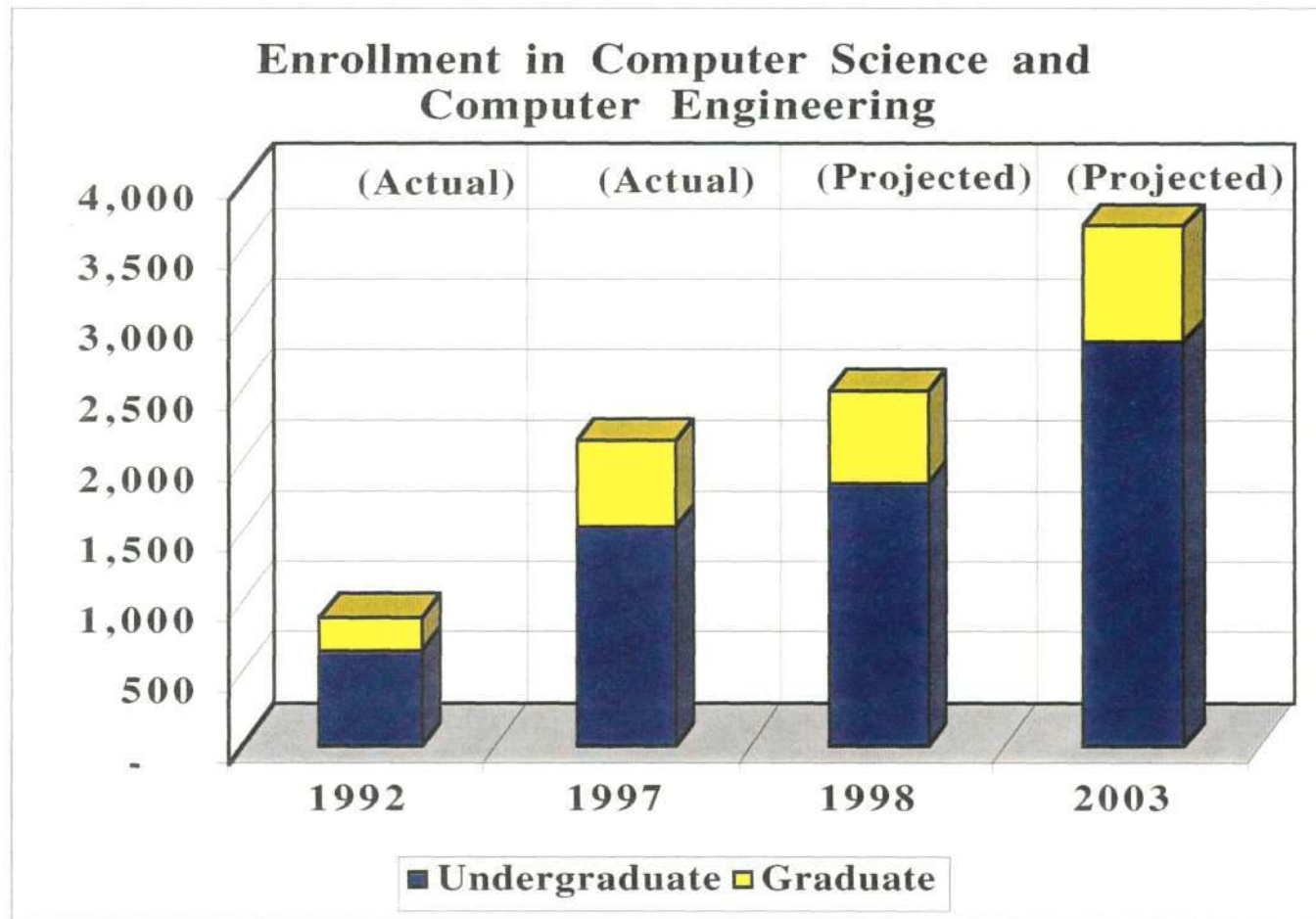

■ **Non-Major Service Course Load Demand Also Increasing...**



■ Capital Project Proposal:

- Expand Computer Science and Computer Engineering
 - 170,000 gross sq ft
 - Total project budget: \$39.5 million
 - Source: \$ 31.5m State and \$ 8.0m Donor

■ Building Program:

- Classrooms / class labs (distance learning)
- Offices / laboratories for faculty & students
- Interdisciplinary research centers

■ Justification:

- Meets existing & projected enrollment needs
- Consolidates Space
- Provides innovative teaching & research space
- Integrates academic disciplines
- Supports economic development

*Georgia Institute
of Technology*



Proposed ACT
Building Site

Interstate 75/85

